

18,881



FILED FOR RECORD
at 12:30 o'clock P M

JUN 25 2024

BECKY LANDRUM
County Clerk, Hunt County, Tex.
By

05/28/2024

Pearce Services,
1222 Vine St, Suite 301,
Paso Robles, CA 93446

5295346 Boring and HH placement

Greetings,

Frontier communications proposes to bore 2262', (6)17"x30" HH, install (1)2'x3' HH, (3)11"x11"x16" drop boxes, 2262' of (1)-1.25" duct along CR 3623 for fiber placing and splicing.

Please, see the attached construction package for location and proposed work details.

If you have any questions, please contact me at any time.

Sincerely,
Darrin Albrecht
Manager, FTTH Quality Control
Central Region
Darrin.l.albrecht@ftr.com
281-229-0849

Submitted by:

Rodney Doyal
Permit Specialist
rodney-doyal@pearce-services.com

County Approval Section:

Approved: _____

Denied: _____

Authorized Signature: _____

Date: _____

**FRONTIER COMMUNICATION
CONSTRUCTION SPECIFICATIONS**

1. Contact Frontier Engineer CORY RIGGS at (310) 210-8882 sixty (60) days prior to need of service in order to confirm requirements, order materials, and schedule work forces.
2. NOTE: FRONTIER COMMUNICATIONS INCORPORATED, RESERVES THE RIGHT TO REFUSE ANY CONDUIT, PULL BOXES, MANHOLES, OR UTILITY BOXES THAT DEVIATE FROM PLANS AND SPECIFICATIONS.
3. All conduit riser bands to have a minimum thirty-six (36) inch radius.
4. All horizontal ninety (90) degree bends shall have a maximum radius of 12.5 feet and all vertical ninety (90) degree bends shall have a minimum radius of three feet. No more than two ninety (90) degree horizontal bends shall be placed in any single run unless otherwise specified. Contact the Frontier engineer concerning any required directions.
5. All conduit must be proven using a mandrel no less than a 1/2" smaller than the conduit placed. Wall to wall measurements must be taken with a measured tape and a 3/8" polypropylene pull rope in each duct. An accurate wall to wall measurement of conduit placed must be As-built on an approved Frontier construction plan. A copy of the As-built conduit work order must be provided to the Frontier Inspector assigned to your project.
6. Place weatherproof caps on all terminated conduits.
7. Approved plastic conduit (PVC Sch. 40, TYPE-C or HDPE (2") is to be used in underground construction unless otherwise specified.
8. Conduit terminated on a pole must be PVC Sch. 80. Location of riser on pole will be called out by engineering on the construction plan.
9. Conduit placed in same trench with primary power conduit must be separated by a minimum of twelve (12) inches of well-packed sand or three inches of concrete, and have a minimum of thirty-six (36) inches of cover when placed behind curb face. All street crossings and conduits placed in the driven portion of the roadway must have a minimum of thirty-six (36) inches of cover to top of pipe. CONTACT THE FRONTIER INSPECTOR 48 HOURS BEFORE TRENCHING AND UPON COMPLETION OF YOUR SUBSTRUCTURES TO SCHEDULE THE FINAL INSPECTION.

CONSTRUCTION PACKAGE

**FDH - 9560 CO RD 3622
CO RD 3622 & CO RD 3623
QUINLAN, TX 75474**

ABBREVIATIONS			
BLDG	BUILDING	PED	PEDESTAL (UTILITY)
CL	CENTER LINE	PVC	POLYVINYL CHLORIDE
CONC	CONCRETE	PL	PROPERTY LINE
CSW	CONCRETE SIDEWALK	RR	RAILROAD
DWY	DRIVEWAY	RR	RIGHT OF WAY
EOC	EDGE OF CURB	SL	STREET LIGHT
EOP	EDGE OF PAVEMENT	W-BLDG	WALL TO BUILDING
ETW	ETW LINE	W-P	WALL TO POLE
HH	HANDHOLE	W-W	WALL TO WALL
MH	MANHOLE	P.U.E.	PUBLIC UTILITY EASEMENT
NTS	NOT TO SCALE	P.S.E.	PUBLIC SERVICE EASEMENT
		C/G	CURB & GUTTER

**PERMITTING AGENCY:
HUNT COUNTY**

PICK UP POINT: CO RD 3623 LIMITS
PATH FOOTAGE: BORE = 7282'
MATERIALS:
(1) NEW 1"X36" NH
(2) NEW 2"X2" NH
(3) NEW 1"X1"X18" DROP BOX
2282' OF (1)-1.25" DUCT



LEGEND	
	River Trench
	River Bank
	Existing Curb
	Existing Water
	Existing Telephone
	Existing Sewer
	Existing Storm Drain
	Existing Electric
	Existing Manhole
	Existing Handhole (5'x5' or 17.5'x17.5')
	BBLAM
	X-CONNECT
	POWER PEDESTAL
	TELCO PEDESTAL
	3' x 5' PULL BOX



**Know what's below.
Call before you dig.**

-HOPE AND PVC FOOTAGE & DO NOT INCLUDE SWEEPS
-ACTUAL FOOTAGES OF HOPE AND PVC WILL BE NEEDED TO ORDER MATERIALS. PLEASE INCLUDE MEASURED TAPE IN ALL PVCS.
-FRONTIER INSPECTOR SHALL BE PRESENT ON SITE WHEN CONTRACTOR NEEDS TO ACCESS ANY EXISTING FRONTIER FACILITY.

Frontier COMMUNICATIONS

JOB ID: 5295348 DATE: 11/24/2022
TITLE: FDH - 9560 CO RD 3622
STREET ADDRESS: 9560 CO RD 3622
CITY/STATE: QUINLAN TX 75474 (HUNT COUNTY)
FTR ENGINEER: CORY RIGGS (310) 210-8882
FTR INSPECTOR: JAMES WEST (817) 578-3774

DRAWN BY: CHC CONSULTING
EST #

CHC CONSULTING
1 OF 6

CURVE	RADIUS	LENGTH	DELTA
C1	3'	5'	91'

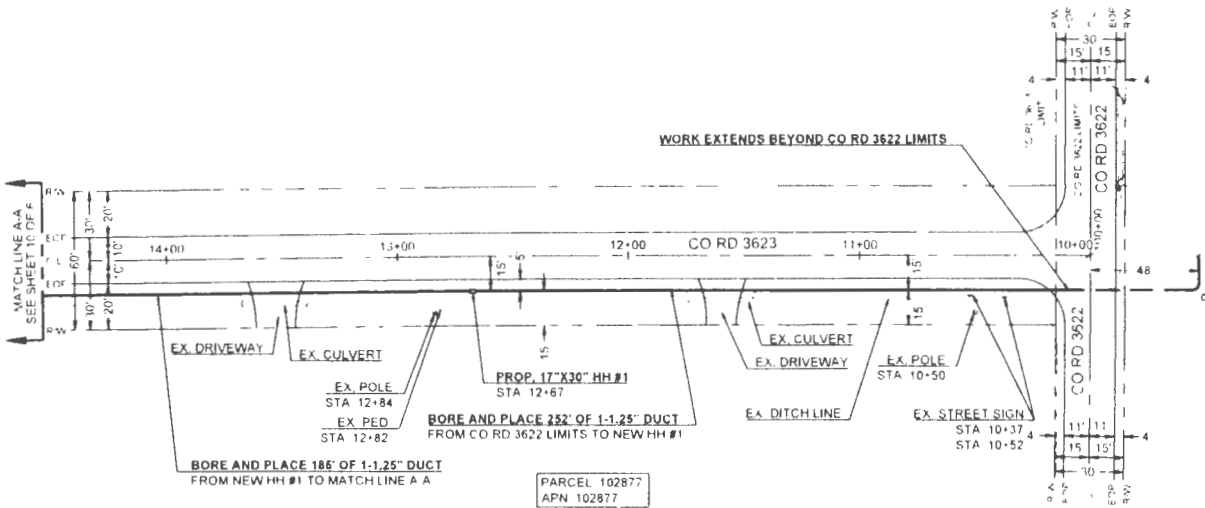

PARCEL 102877
APN 102877

SCALE 1" = 40'



Know what's below.
Call before you dig.

Frontier COMMUNICATIONS

JOB ID: 529534 DATE: 11/24/20
 TITLE: FDM - 940 CO RD 3623
 STREET ADDRESS: 6540 CO RD 3623
 CITY STATE: QUINLAN TX 75149 INT COUNTY:
 ETR INSPECTOR: CONR + PINS + 310 210-6482
 ETR INSPECTOR: JAMES WEST 921-5743 TX

CHC CONSULTING INC. CHC CONSULTING INC.
 PROJECT # SHEET #

2 OF 6

CURVE	RADIUS	LENGTH	DELTA
C1	3'	3'	59'

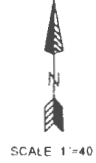
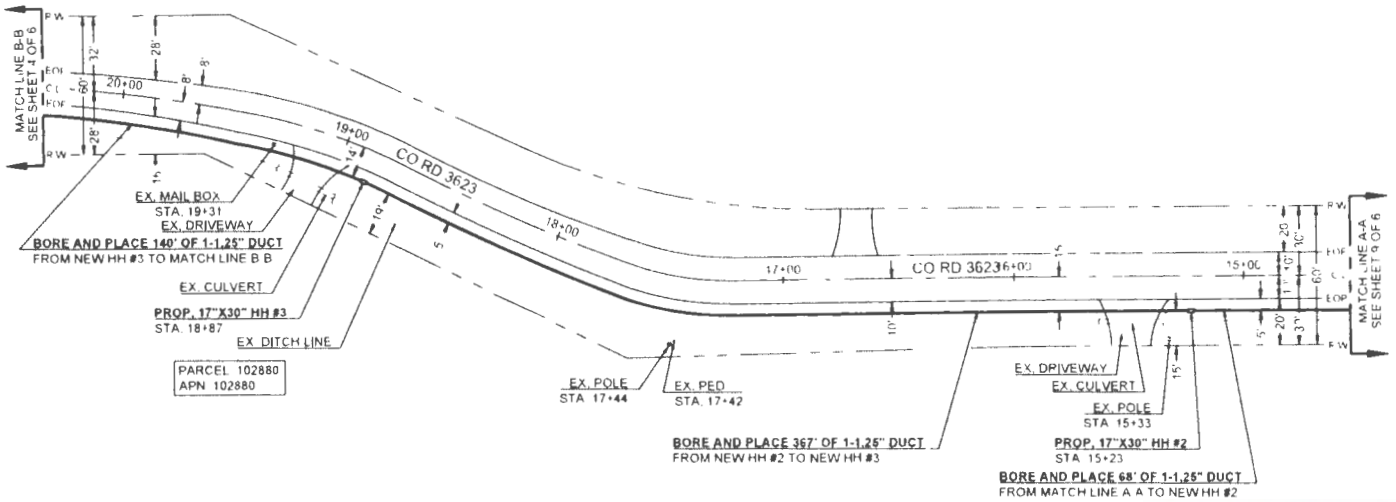

Frontier COMMUNICATIONS

JOB ID: 529514C DATE: 11/24/2022

TITLE: FDN - 9\"/>

CURVE	RADIUS	LENGTH	DELTA
C1	3'	5'	90°

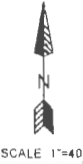
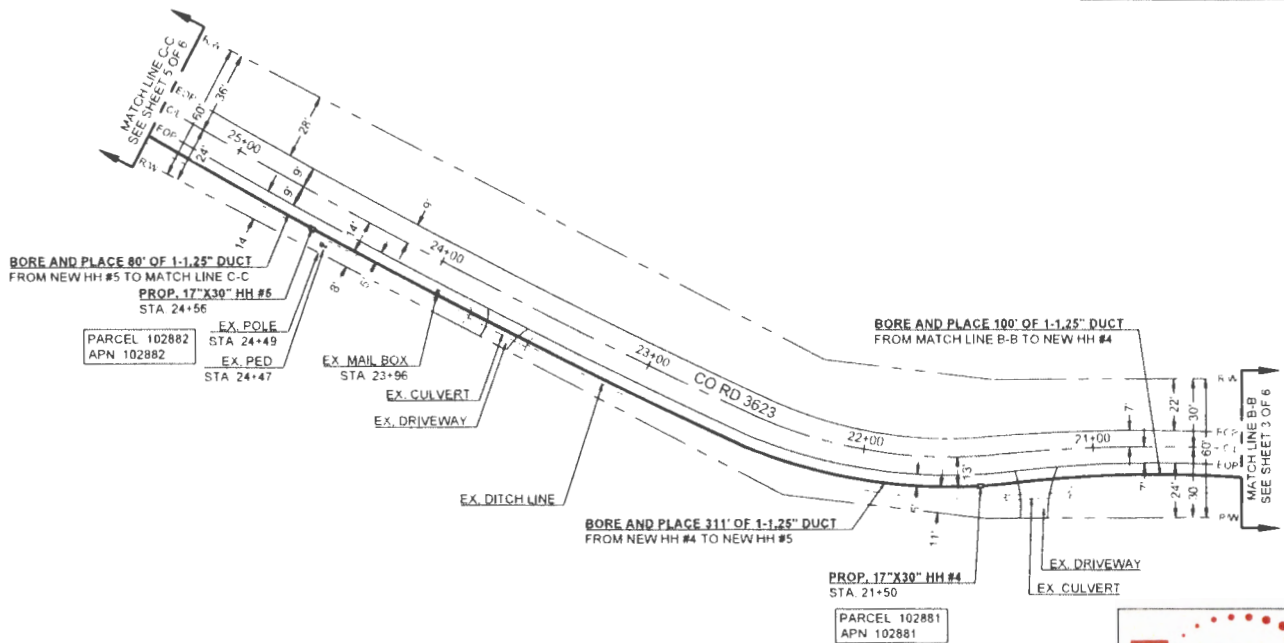

Know what's below.
Call before you dig.

Frontier COMMUNICATIONS

JOB ID: 5295340	DATE: 11/24/2022
TITLE: FDH - 9560 CO RD 3622	
STREET ADDRESS: 9560 CO RD 3622	
CITY/STATE: QUAILAN TX 75474 (HUNT COUNTY)	
CTR ENGINEER: CURRY RIGGS (310) 210-0980	
CTR INSPECTOR: JAMES WEST (972) 578-2224	
CHC CONSULTING EST #	DRAWN BY CHC CONSULTING SHEET #
4 OF 6	



Know what's below.
Call before you dig.



SCALE 1"=40'

Frontier COMMUNICATIONS

JOB ID: 5295345	DATE: 11/24/2022
TITLE: FDH - 9460 CO RD 3623	
STREET ADDRESS: 9540 CO RD 3623	
CITY/STATE: DUBUQUE, IA 52002	
FTR ENGINEER: CORY RIGGS (310) 210-5882	
FTR INSPECTOR: JAMES WEST (872) 578-3224	
DRAWN BY: CHC CONSULTING	CHECKED BY: CHC CONSULTING
DATE: 11/24/2022	DATE: 11/24/2022
SHEET #	5 OF 6

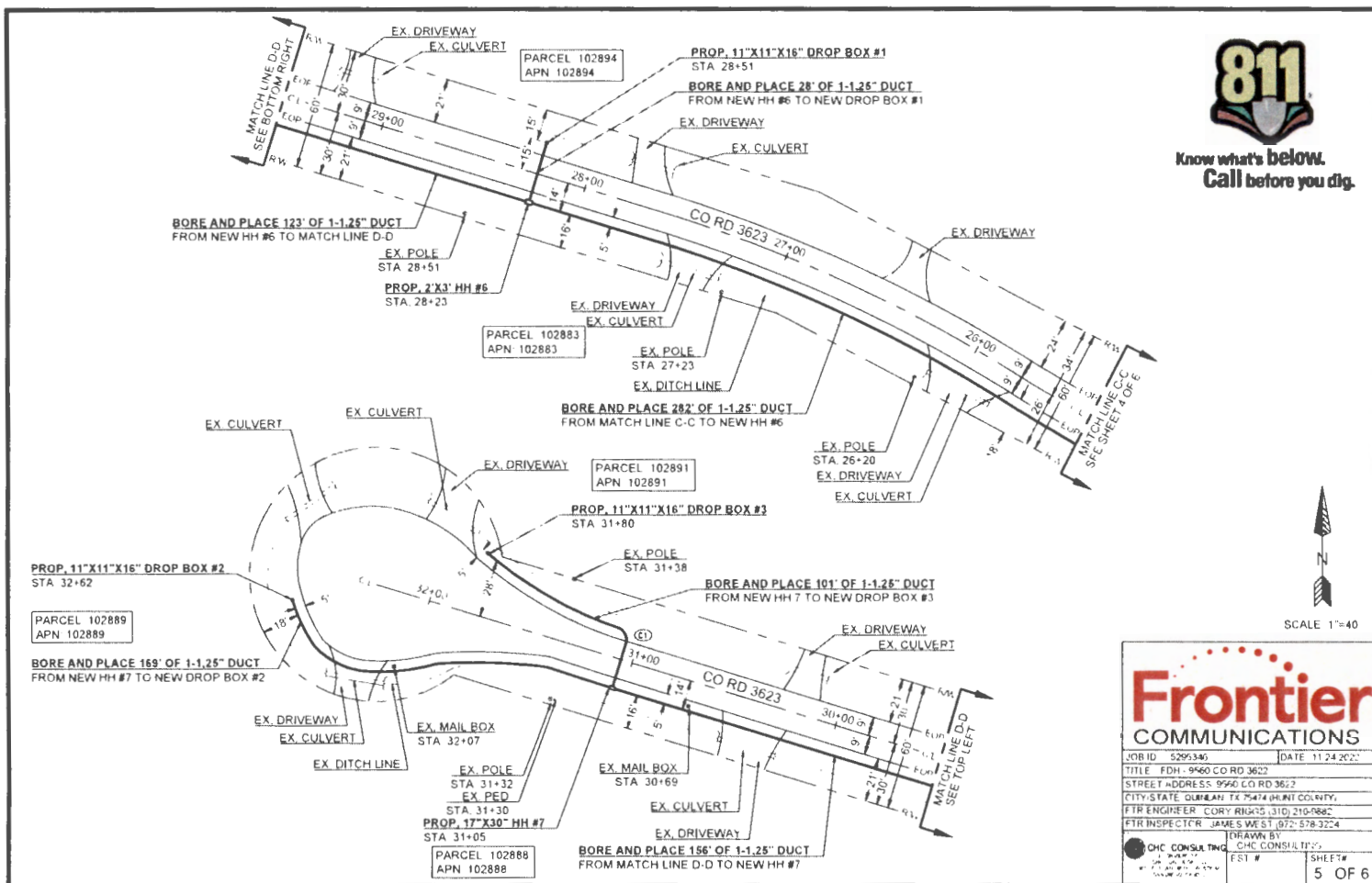

MINIMUM STANDARDS FOR DIRECTIONAL BORING

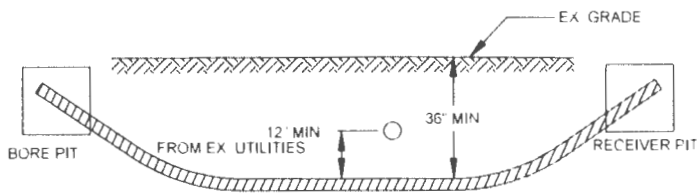

- PLACE END MARKER WITH UTILITY OWNER'S NAME DESCRIBING CONDUIT
- BORE PIT TO BE BACKFILLED AND COMPACTED IN 12' LIFTS WITH MATERIAL REMOVE
- FLOW OF DITCH MUST BE MAINTAINED AT ALL TIMES
- PROTECT ROOTS AT ALL TREE LOCATIONS. SHIFT BORE TRENCH IF NECESSARY

TYPICAL BORE DETAIL

SCALE N.T.S. 1

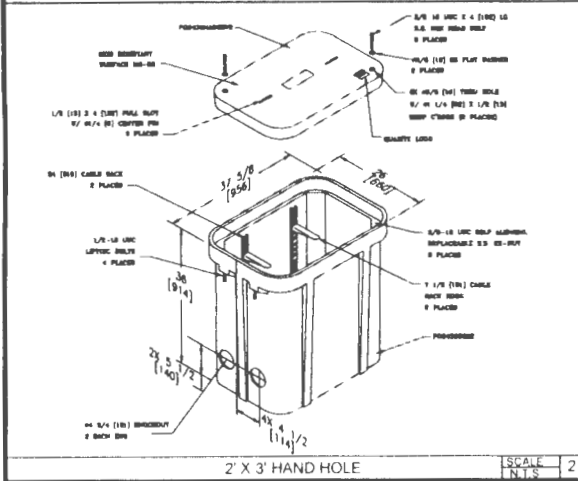

SCALE N.T.S. 2

JOB ID: 5295348	DATE: 7/24/2022
TITLE: FDH - 9560 CO RD 3622	
STREET ADDRESS: 9560 CO RD 3622	
CITY STATE: DUBAN TX 75474 BENT COUNTY	
PTR ENGINEER: CURT RIGGS (310) 210-9882	
PTR INSPECTOR: JAMES WEST (672) 578-3224	
 CHC CONSULTING 1000 N. MICHIGAN ST. SUITE 200 DALLAS, TX 75201	DRAWN BY: CHC CONSULTING EST: # SHEETS: 6 OF 6